

SMOKE RATED CURTAIN SYSTEMS



SmokeFighter® Model D150E

Vertical Coiling Smoke Protection with Egress

McKEON offers a smoke and draft listed curtain assembly at the point of access to an elevator car with a patented egress feature that complies with the exiting requirements of the building codes. The D150E incorporates a vision panel (smoke rated assemblies only) and has been tested without an artificial bottom seal.

Product Features

Fire & Smoke Rating

UL 1784 tested & listed without an artificial bottom seal

Code Compliance

Code Compliance Research Report
CCRR-0455

ASME A17.1 compliant vision panel
when required

ADA compliant

Egress

Available with up to 8 complying swinging
egress doors

Operation

Auto-Set® automatic resetting

Fail-Safe Design - automatic self-closing
mechanism does not require power to
self-close

Size

Widths to 60' and heights to 24'; for larger
sizes and custom configurations consult
the factory

Finishes (metal components only)

McKEON Sterling Gray

Powder Coat of any color as selected

Stainless Steel – No. 4 Polish or

No. 8 Mirror

This technology is the subject of US Patent Nos. 9,440,100; 10,145,174; 10,569,112; and 10,864,394; and has additional patents pending.

D150E

SMOKE RATED CURTAIN SYSTEMS

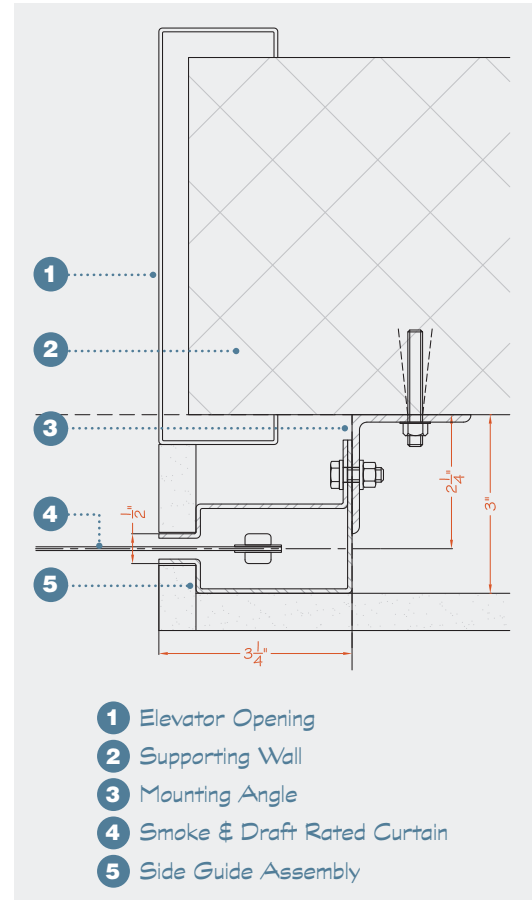
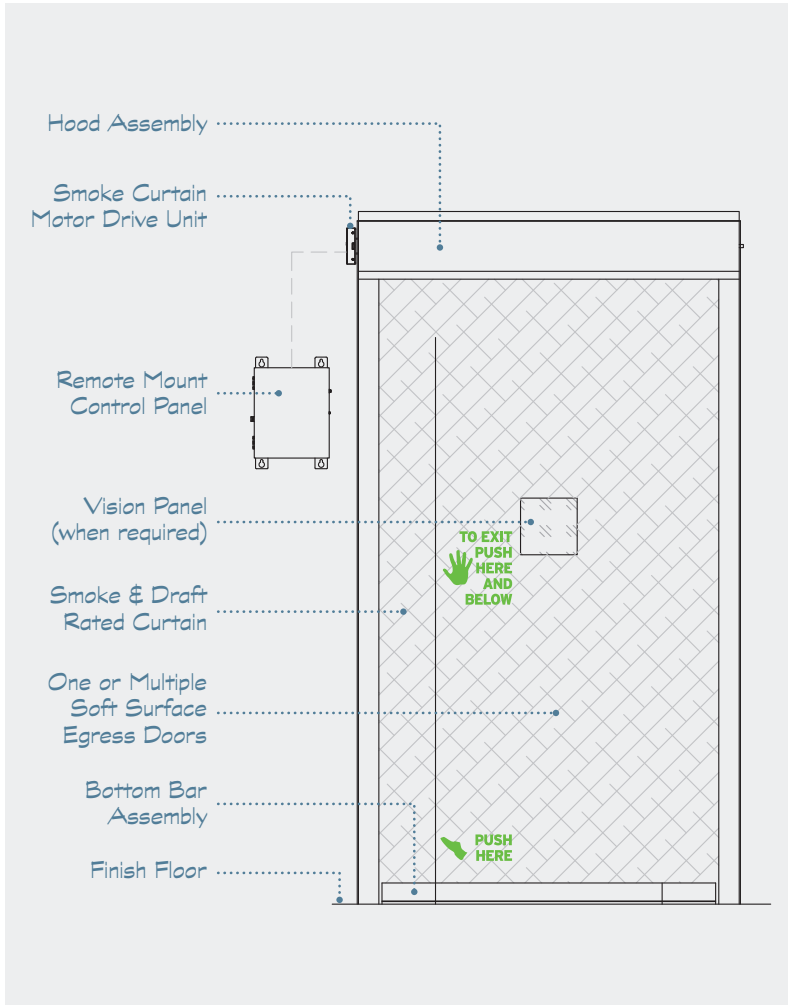

Side guides, with a nominal reveal, can be surface or jamb mounted making them virtually invisible in any application.

MODEL	OPEN	SELF-CLOSE	EGRESS
D150E	Auto-Set® Power Operator	Fail-Safe Mechanical	1 Complying Swing Door
D152E - D158E*	Auto-Set® Power Operator	Fail-Safe Mechanical	2 to 8 Complying Swing Doors

*The last digit of the model number indicates the number of swing doors

